

DIN 444/B

TIRANTE AD OCCHIO PARZIALMENTE FILETTATO

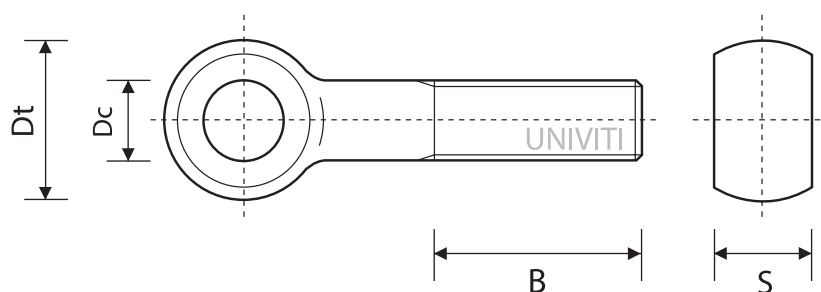

B1 per $L \leq 125$ mm
B2 per $L \leq 200$ mm
B3 per $L > 200$ mm

M	5	6	8	10	12	16	20	24	30
Dc	5	6	8	10	12	16	18	22	27/28
Dt	12	14	18	20	25	32	40	45	55
S	6	7	9	12	14	17	22	25	30
A	11	14	16	18	23	27	32	40	46
B1	16	18	22	26	30	38	46	54	66
B2	/	/	28	32	36	44	52	60	72
B3	/	/	/	/	49	57	65	73	85